

| REVISION |         | RECORD |      |
|----------|---------|--------|------|
| REV.     | CONTENT | MOD.   | DATE |
| △        | 初版发行    |        |      |

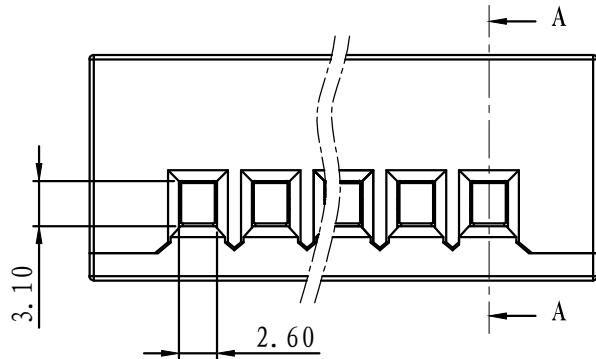
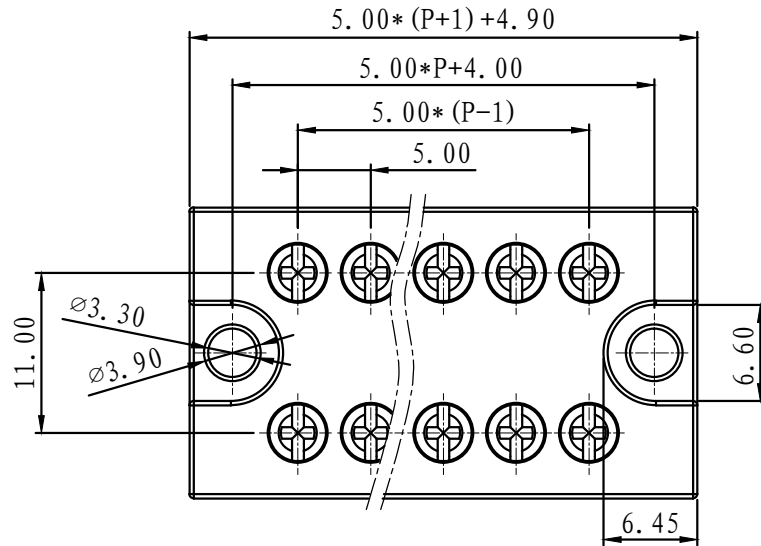

NOTES1:

UL Standard:

1. Voltage Rating: 300V, Current Rating: 15A

IEC Standard:

1. Voltage Rating: 320V, Current Rating: 17.5A

NOTES2:

1. PITCH: 5.0mm
2. Insulation Withstands Voltage: AC2500V/min
3. Insulation Resistance: 500MΩ or more at DC500V
4. Using Temperature Range: -40°C - +105°C
5. Suitable Electric Wire: 26-14AWG
6. Screw Torque Value: 0.4 N.m

技术要求1:

UL 标准:

1. 额定电压: 300V, 额定电流: 15A

IEC 标准:

1. 额定电压: 320V, 额定电流: 17.5A

技术要求2:

1. 间距: 5.0mm
2. 耐受电压值: AC 2500V/min
3. 绝缘阻抗: 500兆欧
4. 使用条件: -40°C - +105°C
5. 适用线规: 26-14AWG
6. 螺丝扭力: 0.4 N.m

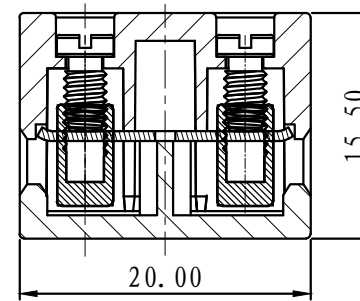

SECTION A-A

|                | pitch dimension |        |         | Nominal dimension |         |         |          |          | —<br>◇<br>○ |
|----------------|-----------------|--------|---------|-------------------|---------|---------|----------|----------|-------------|
|                | over 0          | over 6 | over 10 | over 0            | over 30 | over 60 | over 100 | over 150 |             |
| variable range | to 6            | to 10  | to 24   | to 30             | to 60   | to 100  | to 150   |          |             |
| Tolerance      | ±0.1            | ±0.15  | ±0.25   | ±0.2              | ±0.3    | ±0.5    | ±0.7     | ±1.0     | 0.05/10     |

|      |               |              |          |   |       |                        |                       |
|------|---------------|--------------|----------|---|-------|------------------------|-----------------------|
| 5    | H3802-铜方块     | F1A0BH38023V | 2P       | 黄铜  | 镀镍    |                        |                       |
| 4    | LG128螺丝(十字平头) | SP0YB255103V | 2P       | 磷青铜   | 镀镍    |                        |                       |
| 3    | H3802-导电件     | 4013B0010AV  | P        | 黄铜  | 镀雾锡   |                        |                       |
| 2    | H3802-盖板      | 4013C9101AV  | 1        | PC  | 乳白色   |                        |                       |
| 1    | H3802-本体      | 4013A9101AV  | 1        | PC  | 乳白色   |                        |                       |
| NO.  | NAME OF PART  | NO. OF PART  | Q'TY     | MATERIAL                                      | NOTES |                        |                       |
| DES. | WYY           | DATE         | 23/08/04 | UNITS   | MM    | THIRD ANGLE PROJECTION | SHEET                 |
| CHK. |               | DATE         |          | SIZE  | A4    | 1 of 1                 |                       |
| APP. |               | DATE         |          | SCALE   | 1:1   | DWG NO.                | SP-1-H380250          |
|      |               |              |          |   |       | TITLE                  | H3802-5.0-XXP-191-T0A |
|      |               |              |          | 上海有乐电气有限公司<br>Shanghai YouLe Electric CO.,LTD |       |                        | H3802-成品              |